

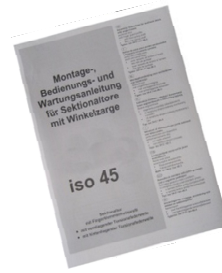

Intelligent Door Solutions



Montageanleitung Schlupftürtor

Assembly instruction passdoor / Notice de pose pour porte sectionelle à portillon /

Instruzioni di montaggio Porta sezionale con porta pedonale/ Montagehandleiding sectionaaldeur met loopdeur

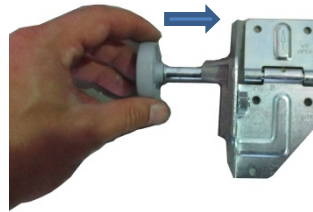

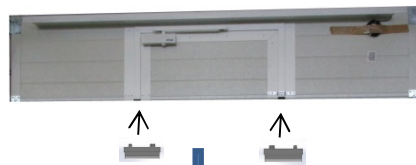
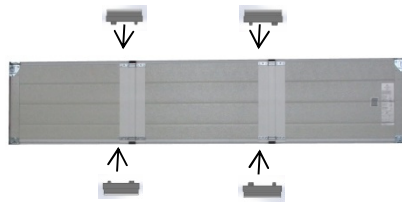
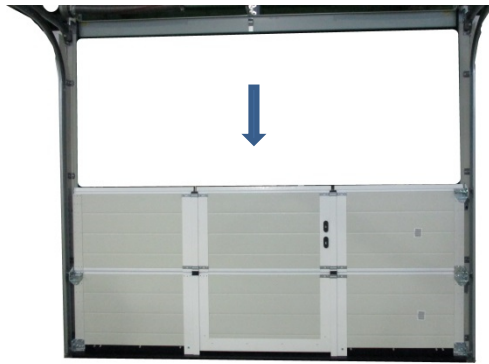
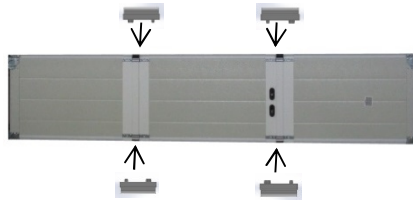

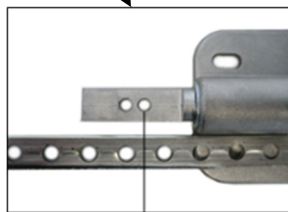
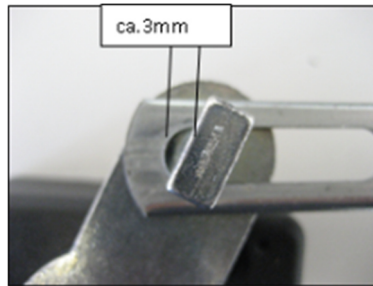
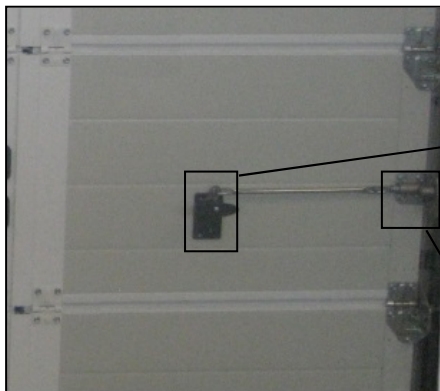
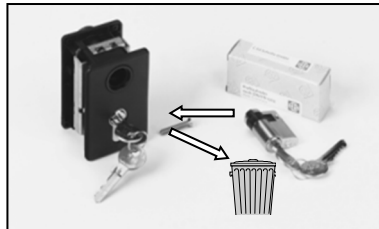
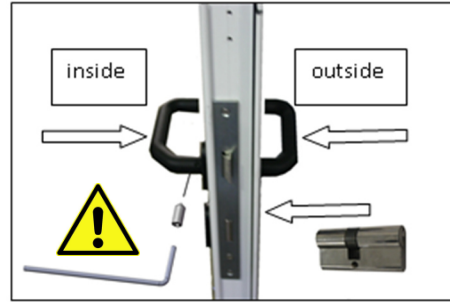

Riegelstange kürzen

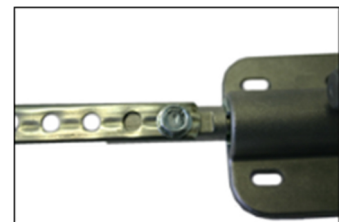

Riegelstange verschrauben

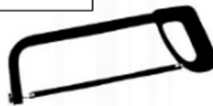

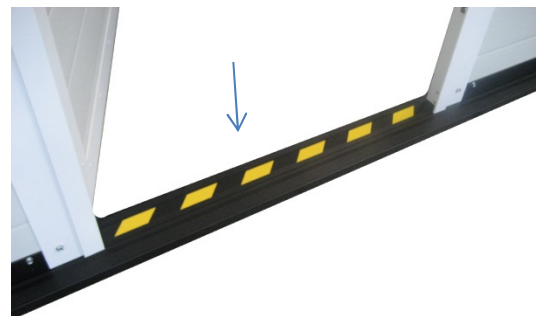
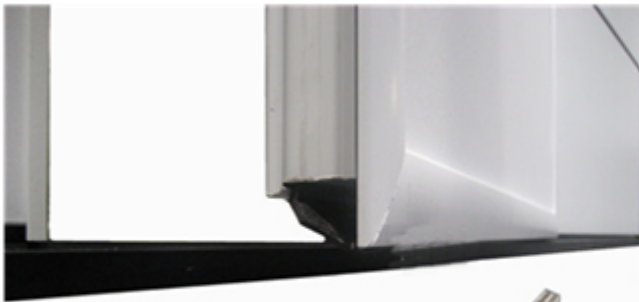

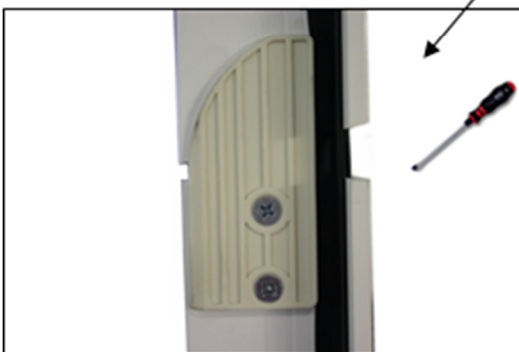

Mat. No.: 11400113 + 11400111

Mat. No.: 11400112 + 11400111

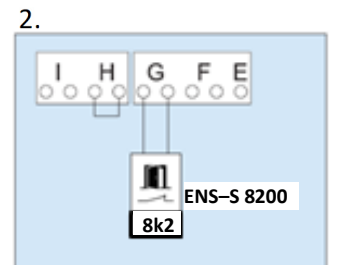

BILD	ART.NR.	BEZEICHNUNG
	11110052	Dichtung Boden STT-4
	30024012	PZ Zylinderpaar gleichschliessend 35,5/35,5 und 30,5 STT-04
	11100044	Abdeckung Dichtung links STT-4
	11100045	Abdeckung Dichtung rechts STT-4
	11400111	Distanzkonturplatte Zarge STT-4
	11400112	Konturplatte Torblatt STT-4
	11400113	Konturplatte Zarge STT-4
	TM2048331332	Schlupftürkontakt 8k2 ENS-S 8200
	11100047	Fingerklemmschutzclip rechts
	11100046	Fingerklemmschutzclip links
	11400129	Riegelblech einfach
	11400130	Schubstück Edelstahl
	NFF15805	Verschwindband
	14301020	Drückergarnitur schwarz PZ Kunststoff
	12000028	Haftetickett (Schwellenkennzeichnung)

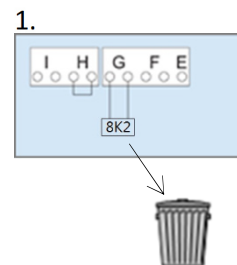
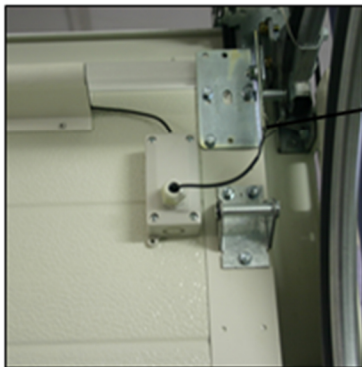
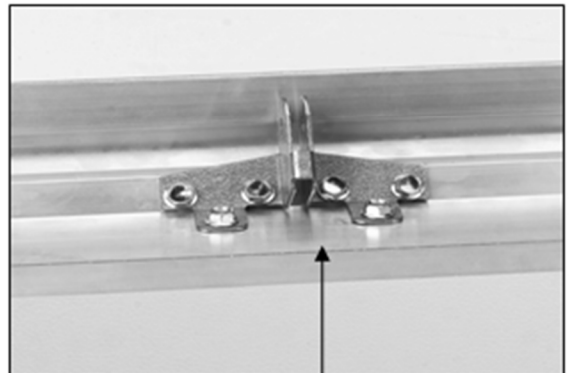
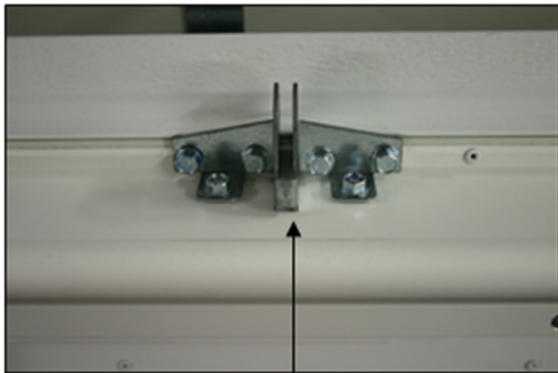
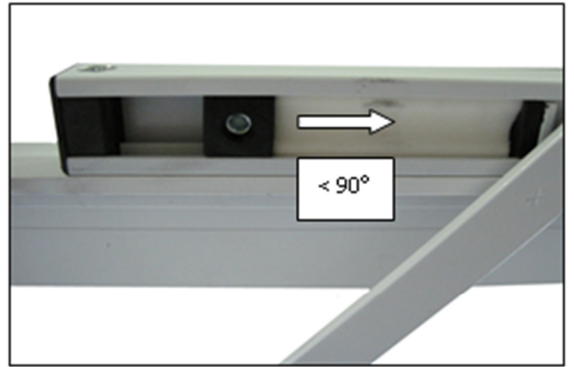